

Car	Audi S6/S7 - C7 - 4.0T	Part No.	SAUS118CF
Year	2012-2018	Fit Kits	473FK
Notes	Where not supplied use original fittings	Features	Pipe Diameter:- 70mm

Estimated Fitting Time: 2 Hours

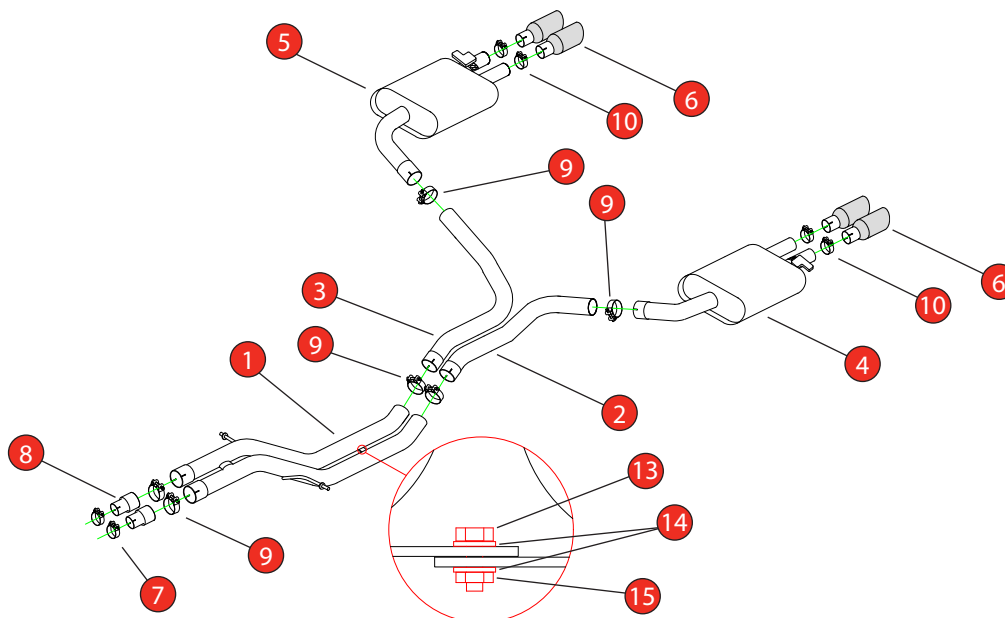

NO.	PART NO.	DESCRIPTION	QTY
1	799AU	Non-resonated Centre Section	1
2	863AU	L/H Rear Link Pipe	1
3	864AU	R/H Rear Link Pipe	1
4	939AU	L/H Valved Rear Silencer	1
5	940AU	R/H Valved Rear Silencer	1
6	Z023.10159	100mm Carbon Fibre Ascari Trim	4
Fit Kit:- 473FK			
7	Z016.10001	59-63mm Clamp (USE TO FIT TO O.E SYSTEM)	2
8	AD40	Adaptor (USE TO FIT TO O.E SYSTEM)	2
9	Z016.10063	72mm H/D Clamp	6
10	Z016.10064	63-68mm Clamp	4
11	Z024.11201	L/H Valve Extension Cable (Not Shown)	1
12	Z017.12732	100 x 2.5mm Black Cable Tie (Not Shown)	3
13	Z017.10044	M8 x 20mm Hex. Head Bolt	1
14	Z017.10831	M8 x 17mm Washer	2
15	Z017.10063	M8 Nut	1

DATE	15/01/2025
ISSUE	01
AUTHORISED	G. O'Shea

NOTE: ENSURE SCORPION SYSTEM IS CLEAR OF MOVING PARTS AND ALL ORIGINAL FUNCTIONS WORK CORRECTLY.



STAY CONNECTED TO RED POWER.

Car	Audi S6/S7 - C7 - 4.0T	Part No.	SAUS118CF
Year	2012-2018	Fit Kits	473FK
Notes	Where not supplied use original fittings	Features	Pipe Diameter:- 70mm



A) After you have removed O.E exhaust you will need to swap the valve motors to the Scorpion exhaust. Remove the 3 nuts (keep safe as you will need them to bolt the electronic valve motor to Scorpion Exhaust).

B) Lift up the motor. You will now be able to see the torsion spring (This must stay on the electronic valve motor to work with Scorpion Exhaust).

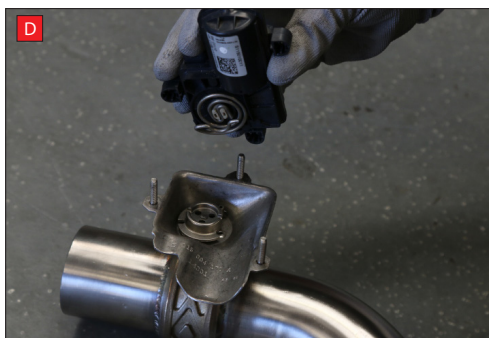

C) Rotate Scorpion valve so it aligns with the torsion spring.

D) Now fit the O.E electronic valve motor ensuring the spring seats correctly to the lugs of the valve.

E) Using the 3 O.E nuts secure in place.



Once happy with fitment of Scorpion Exhaust, fully tighten up all clamps and fixing and plug in the electronic valve motors.